



Medora™

GROUP EVENT SERVICES

EXPLORE. GATHER. SERVE.

HELLO YOU NICE PEOPLE!

The vision for Group Event Services (GES) is to connect people to Medora for positive, life-changing experiences.

We've been inspired by Harold Schafer (the founder of the Theodore Roosevelt Medora Foundation - TRMF) to present opportunities for our guests to experience the Old West, our patriotic heritage, and the life of Theodore Roosevelt in the Badlands.

Whether planning a meeting or a conference for your organization, a wedding, a family reunion, or bringing a motorcoach group, we know that you want to have fun and for everything to be just right, so do we.

Our team has served over four million people since 1965 and no matter your group's specifications, we're grateful to host you while visiting North Dakota's #1 vacation destination: Medora.

We look forward to sharing our vision with you and making your dream become a reality.

TEAM GES





EXPLORE

Medora is a small town with a mighty punch. It's home to around 130 full-time residents year-round and increases to more than 500 people during the summer season with volunteers and staff to support over 3,000 visitors per day during the peak season.

Officially, we are known for the Medora Musical, Pitchfork Steak Fondue, and Bully Pulpit Golf Course. However, we are also home to the Theodore Roosevelt National Park, the North Dakota Cowboy Hall of Fame, and the newly announced Theodore Roosevelt Presidential Library, which is set to open in 2026.

Whether you love Western history, finding peace in the Badlands, or witnessing the best show in the West, we are sure there is more to explore than your eyes could ever imagine.

GATHER

With 12 unique venues and numerous meeting spaces, we can reserve and cater group events.

Our flexible event spaces have room for groups up to 300 plus people. Whether you need half a room for a small session, the Showhall for more intimate groups and meetings, or multiple venues in town, we can make it happen.





*"I love bringing our business to Medora.
It is the perfect place for any age or interest.
Medora has facilities that are close in proximity,
customer service that is outstanding, and an
atmosphere that provides the perfect opportunity for
building strong relationships among employees and
facilitating strategic planning for our company."*

- David
North American Coal Corporation
Bismarck, ND







SERVE

Located in the heart of the Badlands, be prepared for Medora to take your breath away. With the majority of our venues being outdoors, we want to be sure your group has the best experience.

Our goal is to prepare a space suitable to your needs, from social hours to business meetings, to make for a memorable event.

LEGEND TO LEGENDARY

Welcome	1
 Lodging	8
Rough Riders Hotel	9
Badlands Motel	10
Elkhorn Quarters	11
Medora Campground	12
Cabins	13
Conestoga Wagons.....	14
Hyde House and Wooly Boys Inn	15
 Gathering Places	16
Rough Riders Hotel	17
Harold Schafer Heritage Center	19
Elaine's Garden & Andrist Stage	21
DeMore's Park	21
Tjaden Terrace	22
Town Square Showhall	23
Life Skills Center	24
Bully Canyon	26
Old Town Hall Theater	27
Ranch-O-Rama	27
Bully Pulpit	28
Burning Hills Ampitheatre	29
Medora Musical	30
 Catering	31
Theodore's Dining Room	32
Badlands Pizza & Saloon	32
Pitchfork Steak Fondue	33
Reviews.....	34
Room Layouts	35
Venue Capacities	37
Map of Town	38
What To Do	39
Where To Eat	40
Loyal Clients	41
More To Medora	42

LODGING OPTIONS



We are a one-stop destination with four lodging properties: Rough Riders Hotel, Badlands Motel, Elkhorn Quarters, and the Medora Campground. Room allotments are available with an 80% attrition rate, ensuring guests are guaranteed lodging during your event. Reservations within your group's room allotment can be made with a rooming list, or each guest can contact us individually to secure their personal reservation with their own credit card through our in-house reservations center located right here in Medora.

**Rates are subject to seasonality and availability as well as number of rooms pre-reserved. Please contact your event sales representative for specific rates and availability during your stay.*



"Our group [Smithsonian Associates] has been to Medora several times as part of a Theodore Roosevelt tour. Each time we visit, we make it a point to stay at the Rough Riders Hotel. Their dedication to providing the utmost hospitality to us from check-in to check-out is unmatched. TRMF provides a first-class experience all-around!"

- Leah Connolly



Smithsonian Associates



Rough Riders Hotel

OPEN YEAR ROUND

Named for the volunteer cavalry unit led by America's 26th President, Theodore Roosevelt, you'll fall in love the moment you arrive and see the immense hearth reaching to the tin-tiled ceiling, with walls housing one of the largest private (yet available for you to read) library of books on, and by, Theodore Roosevelt.

Rooms are adorned with a touch of the west, the right amount of luxury, and walk-in showers marked by the brands of Roosevelt. If 1880s nostalgia is your thing, ask for one of our historic rooms where it's rumored the President himself may have delivered a speech from the balcony!

STANDARD ROOMS

- Double Queen - sleeps 4
- King - sleeps 2
- Tower Suite - sleeps 4

HISTORIC ROOMS

- Historic Queen - sleeps 2
- Historic King - sleeps 2
- Historic Suite - sleeps 2

76 ROOM CAPACITY

28 King	4 Historic King	3 King ADA
34 Double Queen	3 Historic Queen	2 Queen ADA
1 Suite	1 Historic Suite	

AMENITIES

Iron & Ironing Board	Complimentary Coffee
Refrigerator	Free High Speed WiFi
Walk-in Shower	Fitness Center
Hair Dryer	Restaurant
Complimentary Toiletries	Conference Rooms
HD TV with Cable	Entertainment



Badlands Motel

OPEN MAY - OCTOBER

Drive up to this western-themed motor motel close to it all in Medora. Western-themed furnishings, flat-screen TVs, and mini-fridges, the Badlands Motel has the right mix of amenities for your Medora excursion.

And with the outdoor pool, NEW Point to Point Park activities, children's park, and the best Medora shops just steps from your pillow, the Badlands Motel is the perfect spot for city slicker and cowboy alike!

STANDARD ROOMS

- Double Queen - sleeps 4
- King - sleeps 2
- Suite - sleeps 4

114 ROOM CAPACITY

10 King	6 Queen ADA
91 Double Queen	6 Pet Friendly
1 Suite	

AMENITIES

Mini Fridge	Free High Speed WiFi
Hair Dryer	Entertainment
Complimentary Toiletries	Historic Walking Tours
HD TV with Cable	Outdoor Pool
Complimentary Coffee	





Elkhorn Quarters

OPEN JUNE - EARLY SEPTEMBER

Bringing the spirit of Teddy Roosevelt's Elkhorn Ranch to Medora! Touches of the Maltese Cross and Elkhorn brands adorn your room in homage to Medora's most famous resident, Theodore Roosevelt! The rooms are clean with a touch of Medora western charm.

Your room is as close as you can get to a Maah Daah Hey Trailhead or Bully Pulpit Golf Course — while still having all the creature comforts of staying in Medora.

PLUS: If you book a family room, you can rest assured that the kids will love the bunkbeds and mom and dad will enjoy the added space.

STANDARD ROOMS

- Queen - sleeps 2
- Full - sleeps 2
- Family Unit - sleeps 5

AMENITIES

Walk-in Shower

Hair Dryer

Complimentary Toiletries

HD TV with Cable

Complimentary Coffee

National Park Access

Free High Speed WiFi

Outdoor Pool

Iron & Ironing Board

Entertainment

Historic Walking Tours

195 ROOM CAPACITY

49 Full

83 Queen

44 Family

7 Queen ADA

4 Pet Friendly Full

2 Pet Friendly Queen

6 Pet Friendly Family



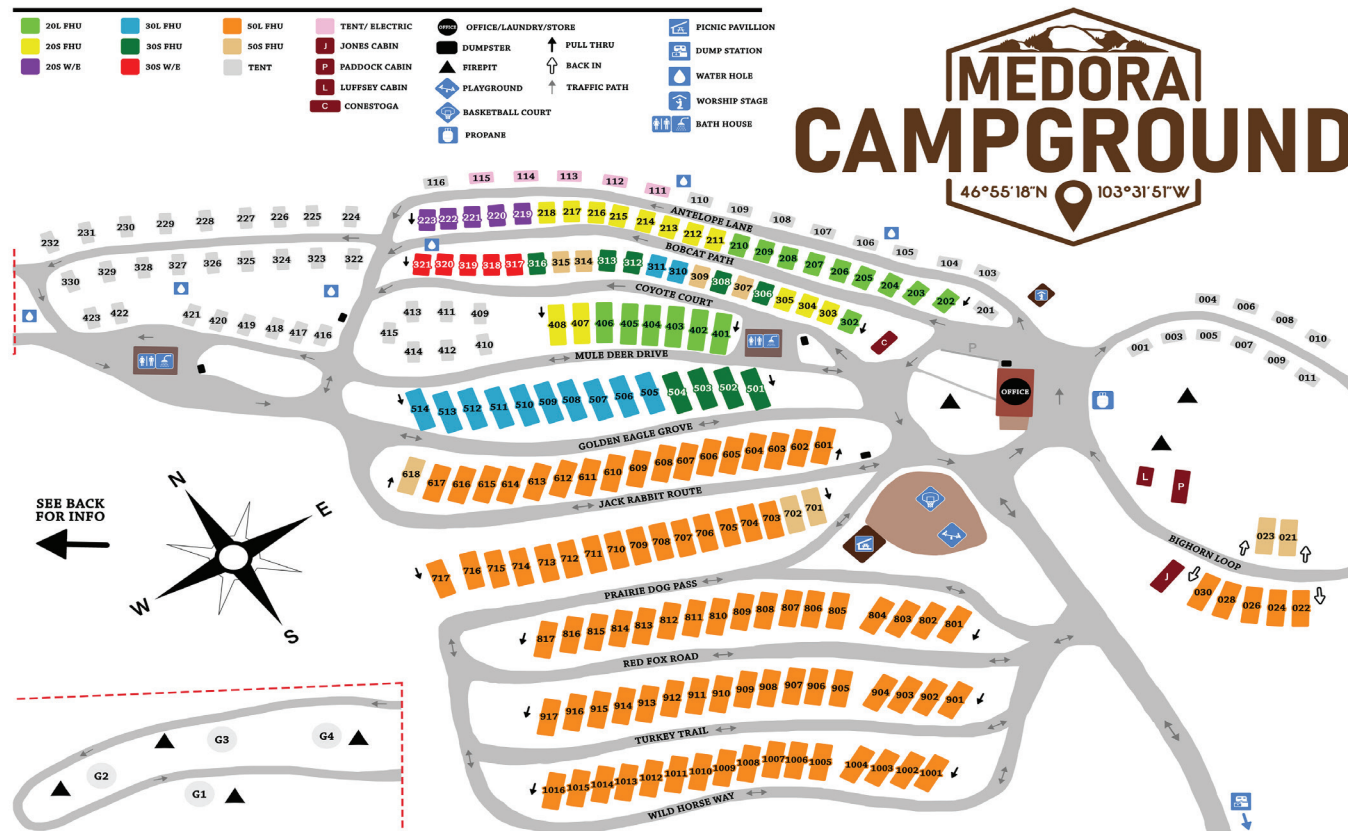

MEDORA CAMPGROUND

46°55'18"N 103°31'51"W

Medora Campground

OPEN MAY - SEPTEMBER

Camp along the Little Missouri River just like Teddy Roosevelt did in 1883!

Conveniently located on the west side of Medora, the Medora Campground is the perfect place to set up your basecamp for adventure in the Badlands.

You can choose between our hook-up spaces or our rugged camping area, whichever makes your Medora experience perfect!

226 CAMPSITES & RV SPACES

RV SPACE TYPE

- 20 AMP Full Hook Ups
- 20 AMP Water & Electric Only
- 30 AMP Full Hook Ups
- 30 Water & Electric Only
- 50 AMP Full Hook Ups

AMENITIES

- | | |
|--------------------------------|-----------------|
| Traditional "Rugged" Campsites | RV Dump Station |
| Cabin Options | Playground |
| Conestoga Wagon Options | Picnic Tables |
| Charcoal BBQ Grills | |



Nestled along the Little Missouri River, our four cabins inside the Medora Campground will make your Medora adventure feel a lot like Teddy Roosevelt's 1883 Medora excursion!

All cabins have a small front porch to watch the Badlands sunrise and ample space to set up camp around the cabin.

The sizes of each cabin vary, but they all sleep 7 or more and linens are provided. See cabin descriptions and amenities listed to the right.

Reservations, check-in, and services for this property are managed by the Medora Campground.

AMENITIES

Charcoal BBQ Grill
RV Dump Station

Playground
Picnic Tables



MEDORA CAMPGROUND CABINS

OPEN MAY - SEPTEMBER

4 CABINS

PADDOCK CABIN

1 Bedroom w/ Queen Bed & loft w/ Full Mattress, 2 Queen-Sized Futons (sleeps 8)

- Private bathroom with shower
- Linens and dishes for 6 are provided
- Air conditioned
- The building is non-smoking and no pets

JONES CABIN

2 Private Bedrooms with Full-Sized Beds, 1 Queen Futon, and Loft with Queen-Sized Mattress(sleeps 8)

- Living area space with countertop, mini-fridge, microwave
- Private bathroom with shower
- Linens and dishes for 8 are provided
- Air conditioned
- The building is non-smoking and no pets

MOORE CABIN

2 Private Bedrooms with Full-Sized Beds, 1 Queen Futon, and Loft with Queen-Sized Mattress(sleeps 8)

- Living area space with countertop, mini-fridge, microwave
- Private bathroom with shower
- Linens and dishes for 8 are provided
- Air conditioned
- The building is non-smoking and no pets

LUFFSEY CABIN

Twin Bunks, 1 Full-Size Bunk, 1 Queen-Size Futon and a Loft with 1 Queen-Sized Mattress (sleeps 7)

- Campground bathroom and shower available for use
- Linens for 7 are provided
- Air conditioned
- The building is non-smoking and no pets

MEDORA CAMPGROUND

CONESTOGA WAGONS

The Conestoga covered wagon was used extensively from 1820 to 1840, in the United States and Canada. Large enough to haul up to 5.5 tons, wagons were used to transport people and materials through rugged terrain and were drawn by teams of horses, mules, or oxen.

Nestled along the Little Missouri River, our Conestoga Wagon in the Medora Campground will make your Medora adventure feel like a true pioneer.

The wagon has ample space to set up camp, enjoy dinner around the custom wagon wheel table, and take in a Badlands sunrise.

Reservations, check-in, and services for this property are managed by the Medora Campground.

3 WAGON CAPACITY - SLEEPS 4

King Bed	Custom Wagon Wheel Table
Twin Bunk Bed	Two Nightstands

OPEN MAY - SEPTEMBER

AMENITIES

Wooden Door with Window	2 LED Overhead Lights
Ductless A/C and Heat Unit	Porch Light Above Door
Wired for 50 Amp	Non-Smoking & No Pets Allowed
7 Electrical Outlets	
3 USB Charging Ports	



Hyde House

Medora's most exclusive lodging property is perfect for a couple's getaway!

Nestled into downtown Medora, the Hyde House is seconds from all the old-west action during the day, and when the stars come out, it's your cozy, well-furnished home for a quiet night's rest.

Photography of Medora's past adorns the walls and offers a glimpse of Medora's historic beginnings.

Reservations, check-in, and services for this property are managed by the Rough Riders Hotel.

AVAILABILITY	AMENITIES	CAPACITY
MAY - SEPTEMBER	Full Bathroom Kitchenette w/ Oversized Fridge Microwave Coffee Maker AC/Heat Non-Smoking & No Pets Allowed	Wrought Iron Queen Bed Custom Historic Furniture (sleeps 2)



Wooly Boys Inn

Nestled under a 100-year-old Cottonwood tree, you can step right out of your front door at the Wooly Boys Inn to grab a coffee, peruse the shops of Medora, or head out on an adventure all your own.

The Wooly Boys Inn has 2 rentable suites — one called “Shuck’s Shack” and the other named “Stoney’s Stall.” The two units are adjoined by a shared door, perfect for a family trip to Medora. And yes, it is named after those Wooly Boys!

Reservations, check-in, and services for this property are managed by the Rough Riders Hotel.

AVAILABILITY	AMENITIES	
MAY - SEPTEMBER	Living Room with Fireplace Large Sofa Table with Chairs TV Kitchenette	Small Refrigerator and Microwave Dishware and Linens Provided AC/Heat Non-Smoking & No Pets Allowed
CAPACITY		
2 Queen Beds (sleeps 4)		



GATHERING PLACES

Historic Medora offers a large variety of spaces to suit your needs. From large conferences, weddings, and events to small board meetings, we will help you choose the perfect place for you.

"Medora is a magical place and any event we have held there has been a success on many levels. TRMF has worked alongside us in Medora from the very beginning and has helped us grow our events to what they are today. They bring a creative and professional approach to all of our projects."

- Lindsey Ybarra



Rough Riders Hotel

Conference Center

WHOLE CONFERENCE ROOM

A historic room to be used as one large space or divided into two smaller rooms.

- 2,340 Square Feet (52' x 45')
- Water, Tea & Coffee Station Included
- Chairs & Tables Complimentary

Capacity:

- Hollow Square - 64
- Crescent Rounds - 100
- Classroom - 122
- Rectangles - 137
- Rounds of 8 - 137
- Theater - 136

HALF CONFERENCE ROOM

The perfect space for your gathering, meeting or break-out session.

- 1,170 Square Feet (26' x 45') / room
- Water, Tea & Coffee Station Included
- Chairs & Tables Complimentary

Capacity:

- U-Shape - 20-40
- Hollow Square - 32
- Crescent Rounds - 35
- Rounds of 8 - 56

ADD ON'S

LOBBY - utilize for registration, set-up, catering needs, and vendors

ADDITIONAL FEES

AV equipment, projector, HDMI connection, podium, whiteboard, handheld microphones, and lapel microphones



Rough Riders Hotel

Metropolitan Patio

A casual outdoor space conveniently located outside the hotel with close proximity to Theodore's Dining Room, TR's Tavern, and Conference Center.

- 2,025 Square Feet (45' x 45')
- Existing Patio Furniture with Tables that seat four
- Closes at 11pm
- No Live Music
- Additional AV Available
- Available Bar Service

Capacity:

- Standing / Social - 130
- Rounds - 45





HAROLD SCHAFFER HERITAGE CENTER

Patio & Bar

Located behind the Harold Schaffer Heritage Center, this outdoor area with a view of the Badlands is great for corporate social hours or gatherings.

- BAR: 288 Square Feet (18' x 16')
- PATIO: 3,360 Square Feet (48' x 70')
- Water, Tea & Coffee Station Included
- Patio Furniture with Tables that seat Four People
- Additional AV Available
- Available Bar Service

Capacity:

- Rounds w/ existing furniture - 74





HAROLD SCHAFER HERITAGE CENTER

Museum

Learn about Harold Schafer and his life, his famous Gold Seal Company which boasted household names like Mr. Bubbles and Glass Wax, how he grew up, and how he worked to rebuild Medora back into a thriving and bustling community. The Harold Schafer Heritage Center Museum is the perfect location for a social or mixer!

- 560 Square Feet (35' x 16')
- Additional AV Available
- Located Inside Harold Schafer Heritage Center

Capacity:

- Rounds - 30-40

HAROLD SCHAFER HERITAGE CENTER

Board Room

A light filled space in the center of town and across from Hidden Springs Coffee Shop. An ideal location for a business, committee, or board meeting.

- 156 Square Feet (12' x 13')
- Chairs & Tables Complimentary
- Additional AV Available
- Located Inside Harold Schafer Heritage Center
- Screen Included

Capacity:

- Conference Room Chairs - 12

ELAINE'S GARDEN & ANDRIST STAGE

Not only does the Andrist Performing Arts Endowment sponsor music and living history, it also created the Andrist Stage located behind the Harold Schafer Heritage Center and Elaine's Garden! This stage features many talented artists each summer and welcomes people to a beautiful part of town!

- 3,827 Square Feet (89' x 43')
- Stage is 276 Square Feet (12' x 23')
- Chairs & Tables not Included*
- Additional AV Available

Capacity:

- Rounds - 64
- Wedding / Ceremony - 200

**For weddings, package pricing available*



DEMORE'S PARK

Located in downtown Medora, the park has a bronze statue of the Marquis de Mores — the founder of Medora — and is dotted with trees and park benches. The statue, donated in 1926 by the Marquis' sons, is surrounded by a flagstone courtyard, which was the result of a 1938 WPA project — a project you can learn more about at the Chateau de Mores Interpretive Center!

- 13,689 Square Feet (117' x 117')
- Chairs & Tables not Included*
- Additional AV Available

Capacity:

- 240 people

**For weddings, package pricing available*



TJADEN TERRACE

Our largest outdoor dining and gathering space on a butte over-looking Medora, the Little Missouri River, and the Burning Hills Ampitheatre.

(June - early September space is only available until 2:30pm. Additional removal fees to be applied for outside tables and/or chairs.)

- 16,200 Square Feet
- Includes use of existing patio furniture, large wooden picnic tables that seat 16 per table
- Additional AV Available

Capacity:

- Yard Space - 200 + people
- Existing picnic tables - 800 people

**For weddings, package pricing available*

TOWN SQUARE SHOWHALL

Located in the heart of downtown, this is our largest indoor space with overhead string lighting.

- 3,680 Square Feet (92' x 40')
- Chairs & Tables Included
- Additional AV Available
- Available Bar Service

Capacity:

- Rectangles and Rounds - 238 people
- Rounds - 216 people

**For weddings, package pricing available*



TOWN SQUARE PATIO

Your guests will enjoy their own outdoor courtyard to gather, dine, or hold a street dance.

- 6,900 Square Feet (60' x 115')
- Picnic Seating for six people per table included
- Additional AV Available
- Available Bar Service

Capacity:

- Full Patio - 33 existing tables (8 per table) 264 people
- Half Patio- 20 existing tables (8 per table) 160 people

**For weddings, package pricing available*



LIFE SKILLS CENTER

Training Room

The training room in our Life Skills Center, it is filled with wide open windows and existing counter space. Great for meetings.

WHOLE TRAINING ROOM

- 1,200 Square Feet (48' x 25')
- Chairs & Tables Included
- Additional AV Available
- Wall mounted Whiteboard Included
- Free WIFI

Capacity:

- Classroom - 70
- U-Shape - 32

HALF TRAINING ROOM

- 600 Square Feet (24' x 12.5")
- Chairs & Tables Included
- Additional AV Available
- Wall mounted Whiteboard Included
- Free WIFI

Capacity:

- Classroom - 36
- U-Shape - 16



LIFE SKILLS CENTER

Rehearsal Room

Adjacent to our Training Room in the Life Skills Center, the Rehearsal Room has floor to ceiling mirrors and hardwood floors. Great for any performance, run-throughs, breakout sessions, lectures, or meetings.

- 2,800 Square Feet (80' x 35')
- Chairs & Tables Included
- Additional AV Available

Capacity:

- Rounds - 120
- Classroom - 90



LIFE SKILLS CENTER: CAFETERIA

- Capacity:** 160 / Patio: 20+
- 2,600 Square Feet (40' x 65')
 - Screen Included
 - Additional AV Available



LIFE SKILLS CENTER: BOARD ROOM

- Capacity:** 11 people - Conference Style
- 272 Square Feet (16' x 17')
 - Screen Included
 - Additional AV Available



LIFE SKILLS CENTER: LANGUAGE ROOM

- Capacity:** Classroom - 20
- 384 Square Feet (16' x 24')
 - Additional AV Available



LIFE SKILLS CENTER: SOUND BOOTHS

- Capacity:** 3 booths
- 100 Square Feet (10' x 10')
 - Sound Proof



BULLY CANYON

On a bluff overlooking the Badlands in a hidden canyon, this outdoor venue presents a spectacular view and is an ideal location for large gatherings, sunrise breakfasts, sunset socials, campfire dinners and more!

(This exclusive venue has limited availability. Please check with your group and event sales representative for details and availability.)

- 6,000 Square Feet
- Propane Fueled Firepit
- Restroom Facilities Can Be Added for an Additional Cost
- Additional AV Available
- Available Bar Service
- Limited Parking, Shuttle Service for an Additional Cost Available

Capacity:

- Fireside Seating: 7-10
- Cocktail Party: 50
- Table Dining with Existing Picnic Tables: 48
- Theater/Wedding Ceremony Seating: 200
- Maximum Capacity: 200



Event Producer: Alyssa Miller

OLD TOWN HALL THEATER

Indoor historic multi-purpose facility where Theodore Roosevelt once gave a speech. Two aisles on each end of the theater lead up to the stage. Multiple spaces left open in the theater seating to accommodate wheelchairs.

- 1,716 Square Feet (39' x 44' x 12'9")
- Private Bathrooms in Lobby
- Large Projector Screen
- Additional AV Available
- Bar Service Available

Capacity:

- Theater - 212



RANCH-O-RAMA

An outdoor arena perfect for hosting a branding, cutting, rodeo, or outdoor gathering event. Become a cowboy here and soak up the real Western Heritage.

- 31,496 Square Feet
- Arena Ground Preparation Included
- Covered Bleacher Seating
- Horse Stalls

Capacity:

- Stadium - 200



Bully Pulpit

Clubhouse Deck & Patio

After your meetings, organize a complete shotgun tournament or reserve a group block of tee-times, then unwind and enjoy the beautiful view with a social gathering.

- 1,200 Square Feet (100' x 12')
- Existing Picnic Tables Included that Seat 35
- Additional AV Available
- Available Bar Service

Capacity:

- Maximum: 75
- Existing Picnic Tables - 30-35



BURNING HILLS AMPHITHEATRE

Looking to host a speaking engagement, plan a unique social hour, or gather for a night to worship and enjoy live music? This outdoor ampitheatre is the spot!

(This exclusive venue has limited availability. Please check with your group and event sales representative for details and availability.)

- 27,060 Square Feet
- Accessible via Walking Path, Escalator, or Elevator
- Restrooms On-Site
- Additional AV Available

Capacity:

- 2,877 Theater Seating

ADD ON'S

- Medora Musical Ticket
- Pitchfork Steak Fondue Ticket
- Shuttle Service
- Popcorn, Candy, & Drinks



MEDORA MUSICAL

If you're looking for fireworks, country western classics, and horses on stage, you've come to the right place. The Medora Musical sings the story of Theodore Roosevelt's time in the Badlands and the founding of Medora. It's the greatest show in the West, professionally produced and casted!

Performed live and outside all summer long, the Medora Musical features original songs and country classics, plus variety acts and new twists every summer. It's a whirlwind of family favorite entertainment.

(Beginning of June - Beginning of September)

"Traveling to Medora has long been a highlight for our tour passengers. From the beauty of the National Park to the excitement of the Medora Musical, there is a wide range of fun activities to appeal to everyone. And working with the Theodore Roosevelt Medora Foundation makes it incredibly easy to plan hotels, activities, and meals all with one friendly representative."

- Caleb Lawson

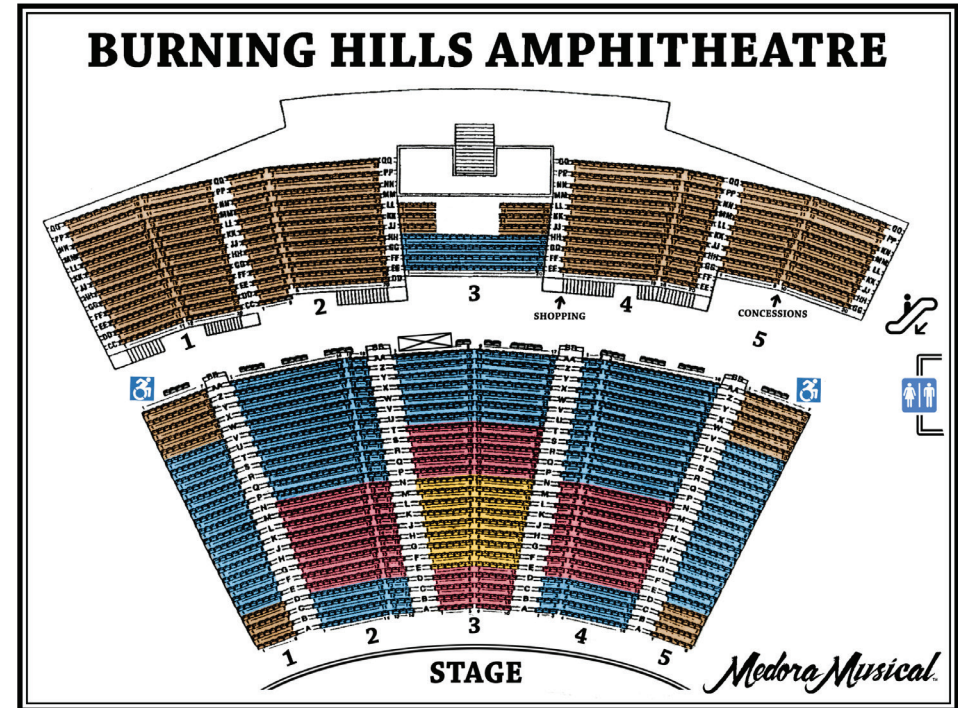

CATERING



Our professional catering staff will cater to your specific needs such as snacks and beverages for break-out sessions, an old fashioned BBQ cookout to relax after a full day of meetings, or gourmet cuisine in an outdoor setting. We can accommodate all of your needs.

The Theodore Roosevelt Medora Foundation (TRMF) offers full catering services so you can fully customize your dining experience. Ask for our catering guide to see more.

*All food, beverage, and alcohol items must be provided by the Theodore Roosevelt Medora Foundation's catering department.
No outside food, beverage, or alcohol is permitted.*



Theodore's Dining Room

Open Year Round

The finest dining this side of the Mississippi!

Groups of 20+ can order off Theodore's menu (1-3 entree choices) and have their meals catered to the Rough Riders Hotel conference center or Metropolitan Patio (venue fees apply). Availability is limited.

- Dining - 2,345 Square Feet (35' x 67')
- Bar - 504 Square Feet (21' x 24')
- Additional AV Available
- Available Bar Service
- Private Bathrooms

Capacity:

- Dining - 105 people
- Bar - 26 people



Badlands Pizza & Saloon

May - December

The perfect grub spot for families!

- 1,710 Square Feet
- Private Bathrooms
- Additional AV Available
- Available Bar Service

Capacity:

- Inside Seating - 152 people
- Outside Seating - 35 people





Pitchfork Steak Fondue

Early June - Early September

Our chefs load up cast iron pitchforks with 12 ounce steaks and fondue them — western style! Paired with all your favorite fixin's and an unbelievable view of the Badlands, this is a perfect dinner any night, and even better when paired with the Medora Musical just a few steps away.

Your steak comes with baked beans, baked potatoes, garlic toast, coleslaw, vegetables, fresh fruit salad, brownies, cinnamon-sugar donuts, lemonade and coffee – all served buffet style. If you want a beer or glass of wine with your steak, we have you covered at the Tjaden Terrace Bar!

New York Strip Steak- 12 oz | Gluten Free, Nut Free, Dairy Free

Beef Hot Dogs | Gluten Free

Hot Dog Buns | Nut Free

The Fixin's

Baked Beans | Gluten Free, Nut Free, Dairy Free

Coleslaw Dressing | Gluten Free, Nut Free

Garlic Toast | Nut Free

Desserts

Cinnamon-Sugar Donuts | Nut Free

Brownies | Nut Free

Capacity:

- Maximum Capacity - 800 people



ADD ON'S

- Medora Musical Ticket
- Medora Gospel Brunch Ticket
- Teddy Roosevelt Show Ticket

REVIEWS

“As a tour director and operator, I am always looking for interesting, quality entertainment along with great food and hotel accommodations. Medora has left an imprint on our hearts that will last for years to come! The quality of entertainment, food, hotel, guest interaction, and intelligent customer service was exceptional from beginning to end!

The Medora Musical was spectacular, from quality musical entertainers to the pyrotechnics and behind the scenes details, this was one of the best shows we’ve seen in a long time! I personally loved the attention to the wholesome honor placed on Teddy and his faith! Thank you, Theodore Roosevelt Medora Foundation, for honoring America and its traditional faith-filled heritage! This will keep us coming back time and time again! And the mountainside theater was shockingly stunning! Well done!

The Pitchfork Steak Fondue was delicious for starters! The steak was so tender and flavorful, we still get comments from our customers almost a year later that this was one of the best meals ever! Additionally, the atmosphere surrounding the dinner was fantastic! Yard games, actor impersonators, live music, this event has it all!

We spent an afternoon with a step on guide, provided by the Theodore Roosevelt Medora Foundation staff, inside the area’s National Park! He was knowledgeable about the area and some Theodore Roosevelt history and kept our group entertained. Our groups so enjoyed their time in the park! Also inside Medora, we had lunch provided with a small presentation at the North Dakota Cowboy Hall of Fame, in town, fully submerging ourselves into Teddy’s Cowboy ND culture. It was a wonderful location to bring a large group! There were more events we could have chosen from, but didn’t have time to choose them all but we look forward to trying some of the others the next time we return.

Finally, I think it’s noteworthy that as a group of about 100 people in 2 motorcoaches were comfortably separated into 2 of the Theodore Roosevelt Medora Foundation hotels, the Badlands Motel & the Rough Riders Hotel. Everyone enjoyed their stays in the very comfortable surroundings in both locations. And though the Rough Riders Hotel is a little more costly, it is definitely more posh and worth the investment for groups. It was historically and artistically well done.

Whether you’re looking for a great 1-2 night stay on your way out West/East or you’re looking for an inspirational final destination, we at JAG Motorcoach would highly recommend considering Medora, North Dakota! You’ll be so glad you did!”

- AmyJo Bazzle



Rough Riders Hotel Conference Room - Whole

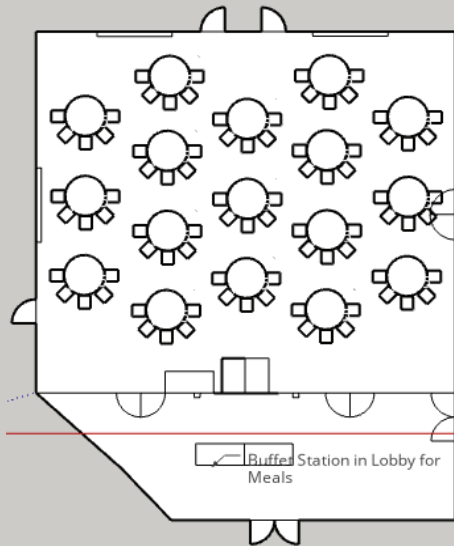

Crescent Rounds - 100 people

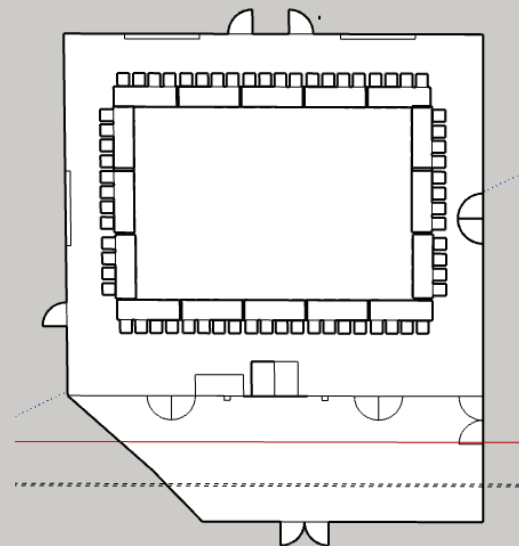

Hollow Square - 64 people

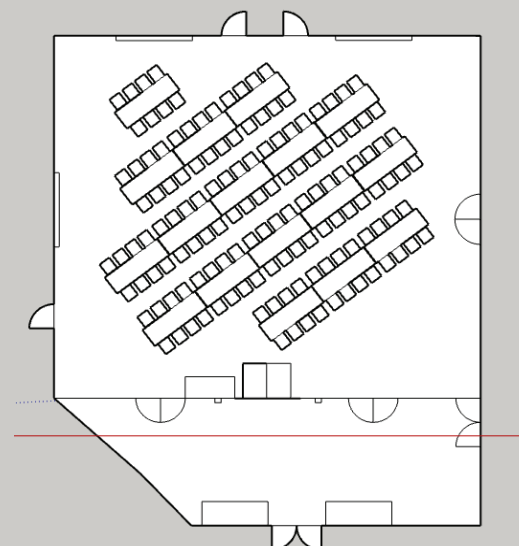

Rectangles - 137 people

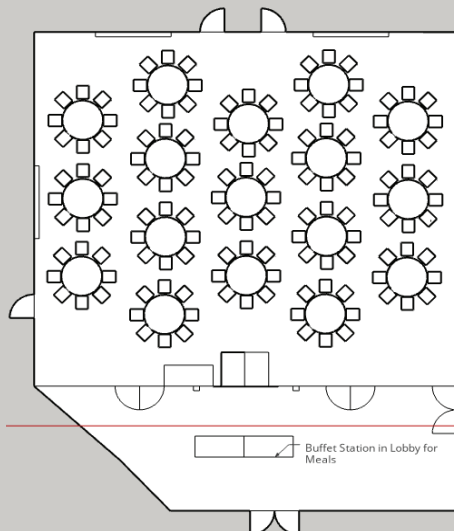

Rounds of 8 - 137 people

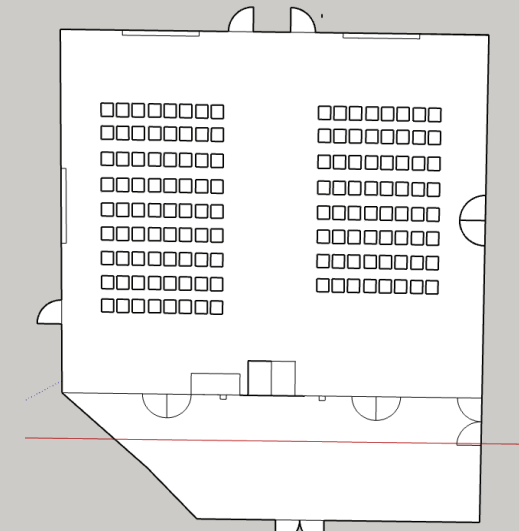

Theater Style - 136 people

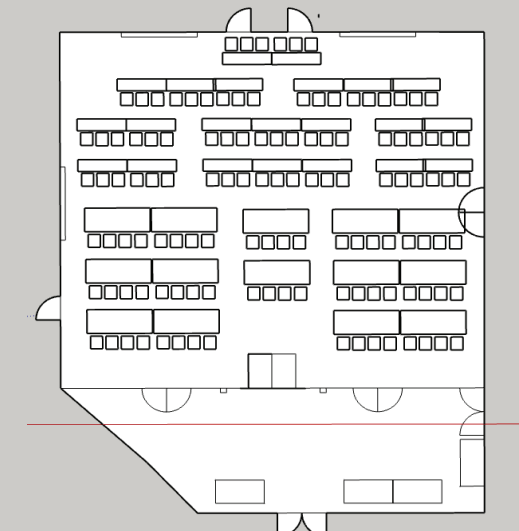

Classroom Style - 122 people

Rough Riders Hotel Conference Room - Half

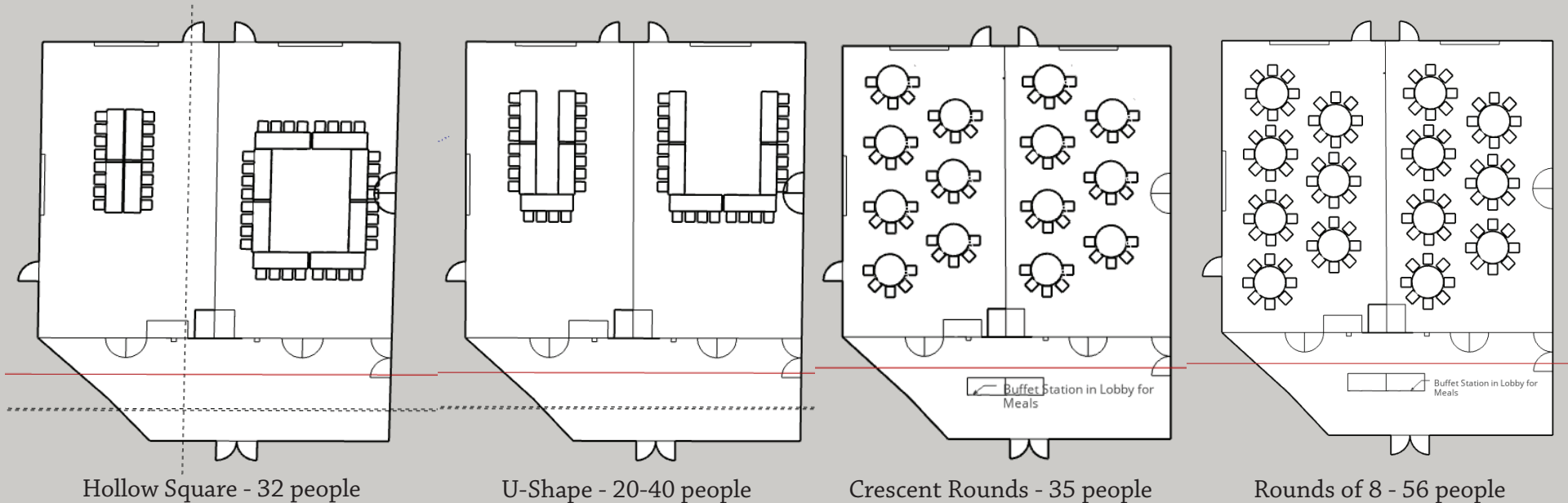

Town Square Showhall

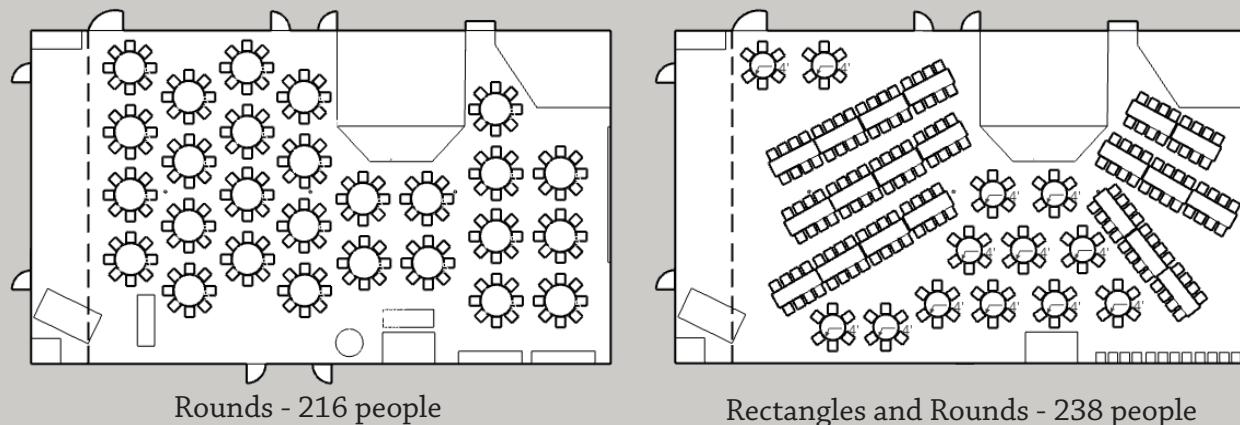

"The team at the Theodore Roosevelt Medora Foundation was professional, responsive, and easy to work with. Our event was held over multiple days and in multiple venues. The TRMF team helped us coordinate the plans to ensure our attendee experience was high-quality and smooth from start to finish. It was a great experience all around!"

- Laiken Aune



Venue Capacities

THEODORE ROOSEVELT MEDORA FOUNDATION

VENUES	THEATER	ROUNDS	CLASSROOM	U-SHAPE	DIMENSIONS	SQUARE FT.
Badlands Pizzeria	-	152	(35 outside)	-	38' x 45'	1,710
Bully Canyon	-	50	-	-	60' x 100'	16,200
Bully Pulpit Clubhouse Deck & Patio	-	30-35	-	-	100' x 12'	1,200
Burning Hills Ampitheater	2,877	-	-	-	123' x 220'	27,060
DeMores Park	-	240	-	-	117' x 117'	13,689
Elaine's Garden	-	64	(wedding / ceremony - 200)		89' x 43'	3,827
Elaine's Garden - Andrist Stage	-	-	-	-	12' x 23'	276
LSC - Board Room	-	-	(conference room chairs - 11)		16' x 17'	272
LSC - Cafeteria	-	160	(patio - 20)		40' x 65'	2,600
LSC - Training Room Whole	-	-	70	32	48' x 25'	1,200
LSC - Training Room Half	-	-	36	16	24' x 12.5'	600
LSC - Language Room	-	-	20	-	16' x 24'	384
LSC - Rehearsal Room	-	120	90	-	80' x 35'	2,800
LSC - Sound Booths	-	-	(3 booths)	-	10' x 10'	100
Ranch-O-Rama	200 Stadium	-	-	-	254' x 124'	31,496
Tjaden Terrace - Yard Space w/ Overlook	200	200+	(800 maximum capacity)		92' x 58'	5,336
Tjaden Terrace - Yard Space w/ Patio	200	200+	(800 maximum capacity)		71' x 109'	7,739
RRH - Metropolitan Patio	-	45	(standing / social - 130)		45' x 45'	2,025
RRH - Conference Room Whole	137	137	122	44	52' x 45'	2,340
RRH - Conference Room Half	72	64	57	33	26' x 45'	1,170
HSCH - Board Room	-	-	(conference room chairs - 12)		12' x 13'	156
HSCH - Bar	-	-	5 chairs	-	18' x 16'	288
HSCH - Patio	-	74	-	-	48' x 70'	3,360
HSCH - Musuem / Gallery	-	30-40	-	-	35' x 16'	560
TSSH - Hall	-	238 (8 per table) 128 (4 per table)	-	-	92' x 40'	3,680
TSSH - Patio	-	-	(full patio - 264 half patio - 160)		60' x 115'	6,900
Old Town Hall Theater	212	-	-	-	39' x 44'	1,716



ENTERTAINMENT

- 1 Medora Musical
- 2 Medora Gospel Brunch
- 3 Town Square Patio
 - The Great American Folk Show
 - Live Music at the Town Square
- 4 Old Town Hall Theater
 - Theodore Roosevelt Show
 - Medora Magic Show
 - Theodore & Edith
- 5 Andrist Stage
 - Legendary: A Campfire Tale

FOOD & DRINK

- 6 Pitchfork Steak Fondue
- 7 Fudge & Ice Cream Depot
- 8 Badlands Pizza & Saloon
- 9 Sheriff Bear's Burgers & Ice Cream
- 10 Theodore's Dining Room

EPIC OUTDOORS

- 18 Theodore Roosevelt National Park
- 19 Bully Pulpit Golf Course
- 20 Maah Daah Hey Trail
- 21 Medora Trail Rides

ACTIVITIES & ATTRACTIONS

- 11 Point to Point Park
 - A Lazy Lil Mo Lazy River & Pool
 - B Manitou the Badlands Zipline
 - C Little Bully Pulpit Mini Golf
 - D Point to Point Trails
 - E Medora Childrens Park
 - F Splash Deck & Jump Pillow
 - G Pickle Ball Court
- 12 Chateau de Mores
- 13 ND Cowboy Hall of Fame
- 14 Footsteps into Medora's Past
- 15 Harold Schafer Heritage Center
- 16 Von Hoffman House
- 17 Badlands Shooting Gallery

SHOPPING

- 22 Medora Musical Welcome Center
- 23 Ticket Junction
- 24 Teddy's Bears
- 25 J.A. Ferris General Store
- 26 Cowboy Lyle's Candy Barn
- 27 Rough Rider Gift
- 28 The Medorable Store

BIG MOMENTS LITTLE PICTURES

Ready, set, selfie! The new Medora selfie passport is curated with handpicked spots that offer the perfect Instagram-worthy backdrops! Scan the qr code to check it out and get to snapping memories!



ONE **BIG LITTLE VACATION**

You can measure Medora by its size. 130 people, give or take. But you can't measure the effect it has on the people who visit. This place speaks to you, the same way it spoke to a young Theodore Roosevelt. It's the way the horizon expands. The way an afternoon moves at its own good time. The way whatever notification lighting up your phone feels a little less important. This place may be a tiny dot on the map. But, by the time you leave, it'll hold a big place in your heart.

WHAT TO DO: ATTRACTIONS



MEDORA MUSICAL



**PITCHFORK STEAK
FONDUE**



THE TEDDY ROOSEVELT SHOW



MEDORA GOSPEL BRUNCH



**MEDORA MUSICAL
BEHIND THE SCENES TOUR**



MEDORA MAGIC SHOW



**THEODORE AND EDITH: A
CONVERSATION WITH THE ROOSEVELTS**



**FOOTSTEPS INTO
MEDORA'S PAST**



MEDORA TRAIL RIDES



**BULLY PULPIT
GOLF COURSE**



**THEODORE ROOSEVELT
NATIONAL PARK**



POINT TO POINT PARK

ASK ABOUT OUR FALL SHOW EXPERIENCES DURING SEPTEMBER, OCTOBER, AND CHRISTMAS PARTIES IN DECEMBER!

WHERE TO EAT:



**PITCHFORK STEAK
FONDUE**



THEODORE'S DINING ROOM



**BADLANDS
PIZZA & SALOON**



**SHERIFF BEAR'S
BURGERS & ICE CREAM**



**FUDGE & ICE CREAM
DEPOT**



MEDORA GOSPEL BRUNCH



**MEDORA UNCORK'D
& ESCAPE ROOM**



**COWBOY LYLE'S
CANDY BARN**



**LITTLE MISSOURI
SALOON & DINING**



COWBOY CAFE



BOOTS BAR & GRILL



HIDDEN SPRINGS JAVA

LOYAL CLIENTS



BlueCross®
BlueShield®



Dakotas Conference
The United Methodist Church

Edward Jones®
MAKING SENSE OF INVESTING



ConocoPhillips

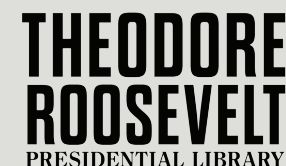

MORE TO MEDORA

In-Town Partners

TRMF is a one-stop-shop for event bookings, attraction tickets, and catering needs. We are proud to partner with the following businesses in and around Medora to make each group's trip an unforgettable experience!

VENUES & LODGING

- AmericInn
 - 75 E River Rd S, Medora, ND 58645
 - (844) 581-4982
- Badlands Ministries
 - 3892 Bible Camp Rd, Medora, ND 58645
 - (701) 623-4332
- Medora Community Center
 - 465 Pacific Ave, Medora, ND 58645
 - (701) 623-4834
- North Dakota Cowboy Hall of Fame
 - 250 Main St, Medora, ND 58645
 - (701) 623-2000
- Theodore Roosevelt Presidential Library (Business Office)
 - 350 3rd Ave, Medora, ND 58645
 - (701) 623-1883

ATTRACTIONS

- Chateau De Mores
 - 3426 Chateau Rd, Medora, ND 58645
 - (701) 623-4355
- North Dakota Cowboy Hall of Fame
 - 250 Main St, Medora, ND 58645
 - (701) 623-2000
- Theodore Roosevelt National Park
 - 315 2nd Ave, Medora, ND 58645
 - (701) 623-4466
- Theodore Roosevelt Presidential Library (Business Office)
 - 350 3rd Ave, Medora, ND 58645
 - (701) 623-1883
- Escape Medora
 - 362 Pacific Ave, Medora, ND 58645
 - (833) 623-2675

DINING / FOOD

- Boots Bar & Grill
 - 300 Pacific Ave, Medora, ND 58645
 - (701) 623-2668
- Cowboy Cafe
 - 215 4th St, Medora, ND 58645
 - (701) 623-4343
- Farmhouse Cafe
 - 314 Pacific Ave, Medora, ND 58645
 - (701) 623-3105
- Hatlee & Brae
 - 394 Pacific Ave, Medora, ND, United States, North Dakota
 - (701) 260-1647
- Hidden Springs Java
 - 350 4th St, Medora, ND 58645
 - (701) 623-4700
- Little Missouri Saloon & Dining
 - 440 3rd St, Medora, ND 58645
 - (701) 623-4404
- Medora Uncork'd
 - 370-378 Pacific Ave, Medora, ND 58645
 - (833) 623-2675

*"Book with us once, and discover the difference.
Book with us again, and create a legacy."*
- TEAM GES



MODERN COMFORT TIMELESS HOSPITALITY

CONTACT

+ 701 - 623 - 4444 Ext:8826

GES@medora.com

MEDORA.COM/GROUPS